

Focus on  
laboratory sample filtration solutions

2019-2020

# SCIDISC

Sample Filtration & Separation

## Syringe Filter

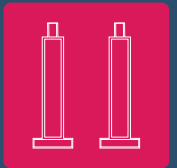
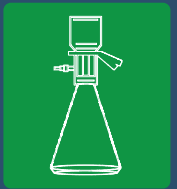

## Design

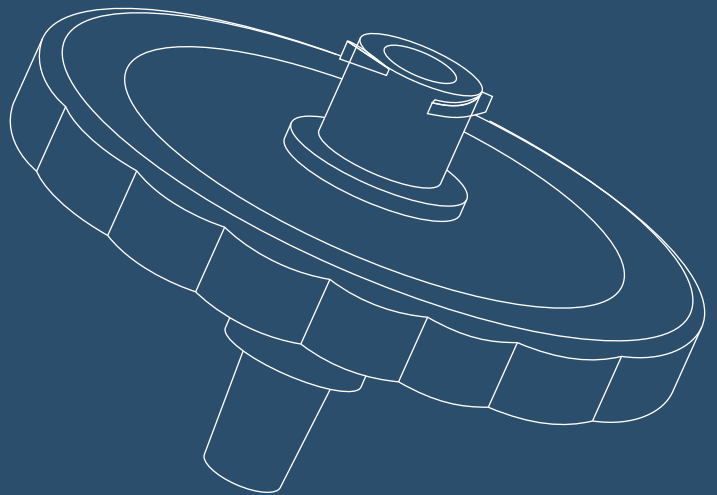
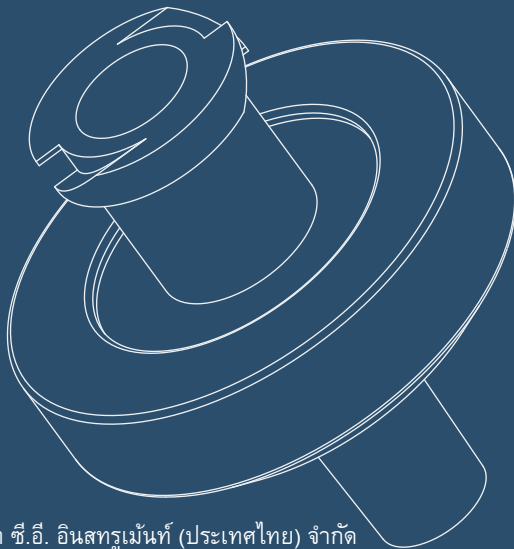

## Manufacture

บริษัท ซี.อี. อินสตรูमेंท์ (ประเทศไทย) จำกัด  
68/876 หมู่ 8 ถนนรัตนวิเบศร์ ต. บางกระสอ  
อ. เมืองนนทบุรี จ. นนทบุรี 11000  
โทรศัพท์ 02 9658971-3 โทรสาร 02 9658974

Email : [sales@cethailand.com](mailto:sales@cethailand.com) [www.cethailand.com](http://www.cethailand.com)



Tianjin Scichro Technologies Co., Ltd.



- ⊙ **High throughputs**
- ⊙ **Low dissolution**

## Satisfied any requires of Filtration process in Laboratory

Ensures good experimental accuracy with widely application in Pharmaceutical, Environmental, Biological, Food analysis, Agricultural test.

**100%**  
satisfied  
guarantee



## SCIDISC series Syringe Filter

### Technical Specification

- Diameter: 13mm and 25mm
- Pore Size:  
0.22µm, 0.45µm, 0.80µm, 1.0µm, 5µm and others
- Membrane Materials:  
MCE, Nylon, PTFE, PES, PVDF, BHP, GF
- Housing Material: Polypropylene  
Color: Polypropylene
- Connections:  
Luer-Lock (Female Connection) and Luer-Lock or Slip (Male Connection)
- Effective filtration area:  
13mm: 1 cm<sup>2</sup>      25mm: 2.8 cm<sup>2</sup>
- Processing volume:  
13mm: 1-10ml      25mm: 10-50ml
- Typical residues:  
13mm: <28µl      25mm: <70µl

**HYDROPHILIC**  
Water accepting or wetting.

**HYDROPHOBIC**  
A membrane or other material which repels and cannot be wetted by aqueous and other high surface tension fluids. When pre-wetted with low surface tension fluid, such as alcohol, the filter will then wet with water.

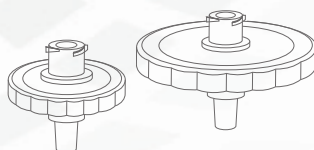

Membrane	Application
Mixed Cellulose Esters (MCE)	<ul style="list-style-type: none"> <li>• Dissolves Completely Using Standard Digestion Procedures.</li> <li>• Cleans completely, possesses low artifacts, and offers minimal interference in fiber counting.</li> <li>• Ideal for Aqueous Solutions.</li> <li>• Low Protein Retention.</li> <li>• 0.22µm for Fluid Sterilization.</li> <li>• Naturally Hydrophilic.</li> </ul>
Polyethersulfone (PES)	<ul style="list-style-type: none"> <li>• Ideal for use in Life Science Applications to Remove Particulates During General Filtration.</li> <li>• Low Protein and Drug Binding Characteristics.</li> </ul>
Nylon (NY)	<ul style="list-style-type: none"> <li>• Ideal for use in General Filtration or Medical Assays &amp; HPLC Sample Preparation.</li> <li>• High Protein Binding Capacity: Immobilizes Antigens, Antibodies &amp; other Proteins.</li> <li>• Naturally Hydrophilic.</li> </ul>
BH Polypropylene (BHP)	<ul style="list-style-type: none"> <li>• HPLC Sample Prep Requiring Low Detection Levels.</li> <li>• Aqueous &amp; Organic Solvent Filtration.</li> <li>• Ion Chromatography.</li> <li>• Naturally Hydrophilic.</li> </ul>
Polytetrafluoroethylene (PTFE)	<ul style="list-style-type: none"> <li>• Filtration of Strong Acids &amp; Aggressive Solvents.</li> <li>• Venting Applications.</li> <li>• Phase Separations.</li> <li>• Strong Hydrophobicity.</li> </ul>
Polyvinylidene Fluoride (PVDF)	<ul style="list-style-type: none"> <li>• Sterilizing Filtration of Biological Solutions.</li> <li>• Clarifying Filtration of Biological Solutions.</li> <li>• Provides High Flow Rates &amp; Throughput.</li> <li>• Low Extractability &amp; Broad Chemical Compatibility.</li> <li>• Hydrophobic.</li> </ul>
Glass Fiber (GF)	<ul style="list-style-type: none"> <li>• Use as a Pre-filter to Extend Membrane Life.</li> <li>• Water &amp; Air Pollution Analysis.</li> <li>• Liquid Clarification.</li> </ul>



**AQUEOUS SOLUTION**



**MCE SYRINGE FITLER**

Naturally hydrophilic , can meet the need of Aqueous sample clarification

**MCE**

Item number	Description	Color	UOM
S13MC-022	13mm, 0.22µm , non-sterile	Green	<b>100pk</b>
S13MC-045	13mm, 0.45µm , non-sterile	Blue	
S13MC-080	13mm, 0.8µm , non-sterile	Violet	
S25MC-022	25mm, 0.22µm , non-sterile	Green	
S25MC-045	25mm, 0.45µm , non-sterile	Blue	
S25MC-080	25mm, 0.8µm , non-sterile	Pink	
ETS13MC-022	13mm, 0.22µm , sterile	Green	<b>90pk</b>
ETS13MC-045	13mm, 0.45µm , sterile	Blue	
ETS13MC-080	13mm, 0.8µm , sterile	Violet	
ETS25MC-022	25mm, 0.22µm , sterile	Green	<b>50pk</b>
ETS25MC-045	25mm, 0.45µm , sterile	Blue	
ETS25MC-080	25mm, 0.8µm , sterile	Pink	

**PES SYRINGE FITLER**

Fast filtration with superior flow rates and high throughputs,Low protein binding and extensive drug compatibility for critical applications

**PES**

Item number	Description	Color	UOM
S13ES-022	13mm, 0.22µm , non-sterile	Aqua	<b>100pk</b>
S13ES-045	13mm, 0.45µm , non-sterile	skyblue	
S13ES-080	13mm, 0.8µm , non-sterile	Lightorange	
S25ES-022	25mm, 0.22µm , non-sterile	Aqua	
S25ES-045	25mm, 0.45µm , non-sterile	skyblue	
S25ES-080	25mm, 0.8µm , non-sterile	Lightorange	
ETS13ES-022	13mm, 0.22µm , sterile	Aqua	<b>90pk</b>
ETS13ES-045	13mm, 0.45µm , sterile	skyblue	
ETS13ES-080	13mm, 0.8µm , sterile	Lightorange	
ETS25ES-022	25mm, 0.22µm , sterile	Aqua	<b>50pk</b>
ETS25ES-045	25mm, 0.45µm , sterile	skyblue	
ETS25ES-080	25mm, 0.8µm , sterile	Lightorange	

**GF SYRINGE FITLER**

Glass fiber media provide utility in a variety of life sciences applications requiring efficient clarification of aqueous-based solutions.

**GF**

Item number	Description	Color	UOM
S13GF-045	13mm, 0.45µm , non-sterile	Seagreen	<b>100pk</b>
S13GF-080	13mm, 0.8µm , non-sterile	Maize	
S25GF-045	25mm, 0.45µm , non-sterile	Seagreen	
S25GF-080	25mm, 0.8µm , non-sterile	Maize	
ETS13GF-045	13mm, 0.45µm , sterile	Seagreen	<b>90pk</b>
ETS13GF-080	13mm, 0.8µm , sterile	Maize	
ETS25GF-045	25mm, 0.45µm , sterile	Seagreen	<b>50pk</b>
ETS25GF-080	25mm, 0.8µm , sterile	Maize	



ORGANIC SOLUTION



**NYLON66 SYRINGE FITLER**

Excellent chemical compatibility with esters, bases, and alcohols, Naturally hydrophilic, Useful for a wide range of applications. Offers broad chemical resistance to common solvents.

**NY66**

Item number	Description	Color	UOM
S13NY-022	13mm, 0.22µm , non-sterile	Yellow	<b>100pk</b>
S13NY-045	13mm, 0.45µm , non-sterile	White	
S13NY-080	13mm, 0.8µm , non-sterile	Orange	
S25NY-022	25mm, 0.22µm , non-sterile	Yellow	
S25NY-045	25mm, 0.45µm , non-sterile	White	
S25NY-080	25mm, 0.8µm , non-sterile	Orange	
ETS13NY-022	13mm, 0.22µm , sterile	Yellow	<b>90pk</b>
ETS13NY-045	13mm, 0.45µm , sterile	White	
ETS13NY-080	13mm, 0.8µm , sterile	Orange	
ETS25NY-022	25mm, 0.22µm , sterile	Yellow	<b>50pk</b>
ETS25NY-045	25mm, 0.45µm , sterile	White	
ETS25NY-080	25mm, 0.8µm , sterile	Orange	

**BHP SYRINGE FITLER**

Provide high particle retention, high dirt holding capacity and low pressure drop. it is designed for filtration of organic solvents , also for the filtration of aqueous solutions.

**BHP**

Item number	Description	Color	UOM
S13BH-022	13mm, 0.22µm , non-sterile	Magenta	<b>100pk</b>
S13BH-045	13mm, 0.45µm , non-sterile	Purple	
S25BH-022	25mm, 0.22µm , non-sterile	Magenta	
S25BH-045	25mm, 0.45µm , non-sterile	Purple	
ETS13BH-022	13mm, 0.22µm , sterile	Magenta	<b>90pk</b>
ETS13BH-045	13mm, 0.45µm , sterile	Purple	
ETS25BH-022	25mm, 0.22µm , sterile	Magenta	<b>50pk</b>
ETS25BH-045	25mm, 0.45µm , sterile	Purple	

**PTFE SYRINGE FITLER**

Strong Chemically Resistant Membranes for Sampling in Aggressive Environments, Ideal for filtration of organic solvents. Hydrophobic for Aggressive Environments, Ideal for venting and gas filtration .

**PTFE**  
Hydrophilic  
Hydrophobic

Item number	Description	Color	UOM
S13PT-022	Hydrophilic	Red	<b>100pk</b>
S13PT-045		Violet	
S25PT-022		Red	
S25PT-045		Violet	
S13PT-022B	Hydrophobic	Magenta	<b>100pk</b>
S13PT-045B		Purple	
S25PT-022B		Magenta	
S25PT-045B		Purple	
ETS13PT-022	Hydrophilic	Red	<b>90pk</b>
ETS13PT-045		Violet	
ETS25PT-022		Red	<b>50pk</b>
ETS25PT-045		Violet	



## AQUEOUS & ORGANIC SOLUTION

### PVDF SYRINGE FITLER

Useful for a wide range of applications including aggressive and non-aggressive solvent-based samples



## PVDF

Hydrophilic

Item number	Description	Color	UOM
S13PV-022	13mm, 0.22µm , non-sterile	Orange	<b>100pk</b>
S13PV-045	13mm, 0.45µm , non-sterile	Pink	
S25PV-022	25mm, 0.22µm , non-sterile	Orange	
S25PV-045	25mm, 0.45µm , non-sterile	Pink	
ETS13PV-022	13mm, 0.22µm , sterile	Orange	<b>90pk</b>
ETS13PV-045	13mm, 0.45µm , sterile	Pink	<b>50pk</b>
ETS25PV-022	25mm, 0.22µm , sterile	Orange	
ETS25PV-045	25mm, 0.45µm , sterile	Pink	

## STERILE SYRINGE FILTER

### Medical grade package

The packing of sterile syringe filter is made of medical grade PVC and Aluminum materials. Both sterilization performance and safety condition are secured.

### ETO(Ethylene oxide)

ETO(Ethylene oxide) is one of best sterilization reagent, its capable of removal of all kinds of Microbiological features such as bacterial spore. ETO has very strong penetrability during sterilization process, which fits medical level of packing materials, ETO is very good choice in terms of product such as syringe filter which does not work on high - Temp or high humid condition.

### Single-pack

The packing method ensures easy usage (just break through PTP film). PVC material does not contain softening agent, Non-toxic and Non-polluting, with long-life storage.

### Color distinction membrane

The transparent packing is used for product distinguish, each syringe filter has its own featured color with corresponding specification, customers can pick up what suits their the best by selecting colors.



## Enhances your selection of OEM requires

We are capable of customized products according to our customer's require: specification, packing, imaging etc. We offer our customer's best solution for their desired product with our strong production facility and high level of designing.

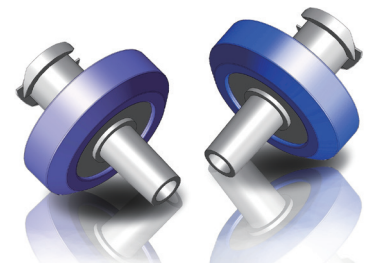

Supply of OEM products with flexibility



## SS FILTER

### SS-HOUSING SYRINGE FITLER

- Lightweight design, flexible, easy to clean
- Easy to operate, silicone-ring sealing
- Corrosion resistant, autoclave at 121°
- Specially suitable for plasticizer samples



#### Specification

Housing : SUS316    Screen support: SUS316    sealing : Silicone-ring

#### Product Information



Item	SF13	SF25	SF50
Part.No.	420513-25	420523-26	420533-27
membrane diameter(mm)	13	25	50
UOM package(ea/pk)	1	1	1

## Q&A How to choose ?

### STEP 1 : CHOOSE THE SUITABLE MEMBRANE FILTRATION MEDIA?

Characteristics of samples

**Aqueous**

MCE  
PES  
NYLON

**No Polar**

NYLON  
PTFE  
PVDF

**Protein**

PES  
PVDF

### STEP 2 : CHOOSE THE SUITABLE DIAMETER?

Volume of samples

**1-10ml**

13mm

**10-50ml**

25mm

**over 50ml**

50mm

### STEP 3 : CHOOSE THE SUITABLE PORE SIZE?

Micron size of column

**< 3um**

0.22µm

**> 3um**

0.45µm

